

## Futura Sink Mixer with Pullout Spray 02-4353

### Hose Requirements for mixers

The maximum working pressure of the ceramic cartridge is 1000kPa.  
Do not hydrostatic test the installation with this mixer installed. Damage to the ceramic cartridge may occur.

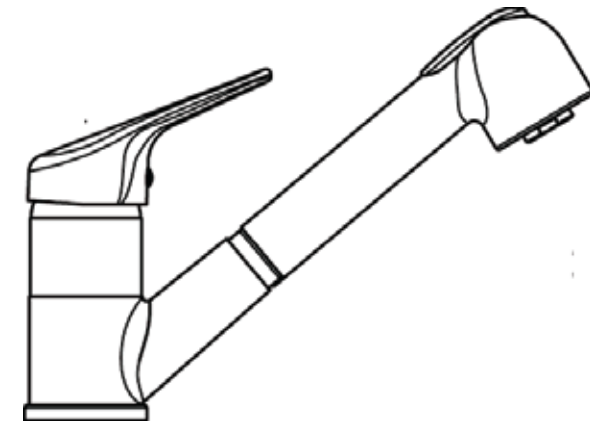
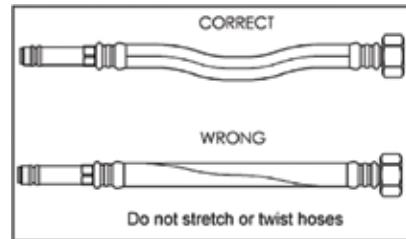
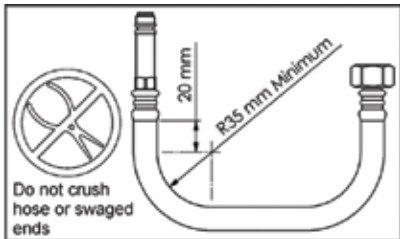

Illustration may not reflect actual product shape.

## Installation Guide

### “In situ” testing

The maximum working pressure of the ceramic cartridge is 1000kPa. Do not hydrostatic test the installation with this mixer installed. Damage to the ceramic cartridge may occur, voiding our warranty.

### IMPORTANT

**Please read all of the instructions before installation**

Use of this product in non-domestic applications voids warranty.  
All pipe work must be thoroughly flushed prior to the installation of the mixer.  
NEFA inline filters must be installed on both hot and cold supplies.  
Do not remove the ceramic cartridge from the mixer when installing.  
Damage caused by hydrostatic testing is not covered by our warranty.



## Technical Specifications

Inlet Connections: All 1/2' BSP  
 Operating Pressure: 150kPa - 500kPa  
 Operating Temperatures: Recommended hot water supply 50°C, maximum 70°C. AS 3500 requires all hot water supplies to any sanitary fitting to be tempered to 50°C.

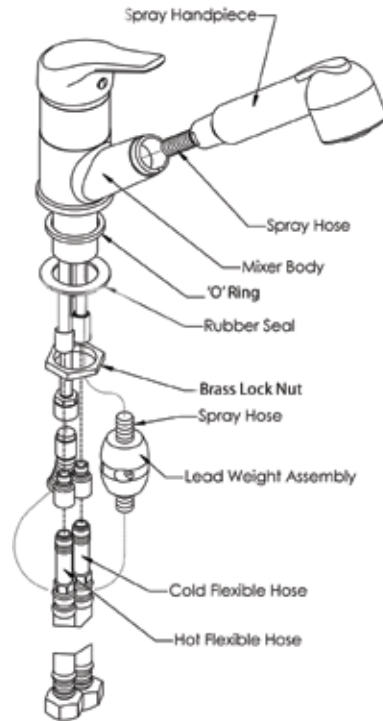

## Installation

1. Cut a 40mm diameter hole through the bench top. Ensure the thickness of the bench top does not exceed 30mm.
2. Remove the rubber seal washer and brass lock nut.
3. Fit the 'o' ring sealing washers (provided in a separate bag) over the tail pipes and push it up to fit against the underside of the sink faucet.
4. Secure the 'hot' hose into the left hand of the two shorter pipes when viewed from the front. Secure the 'cold' hose into the right hand of the two shorter pipes when viewed from the front.
5. Place the mixer body and hoses through the hole cut in the bench top. (NB: The hoses will need to be placed through the holes one at a time).
6. Place the rubber seal washer over the hoses to form a seal on the underside of the bench.
7. Secure the faucet in place using the brass backnut, against the underside of the bench.
8. Screw the pull out spray handpiece into the conical end of the spray hose, ensuring firm seal is made with the sealing washer within the hose's conical end fitting.
9. Place the smaller threaded end of the pull out spray hose through the faucet spout opening. Push the hose down the spout and through the faucet body until it exits out the bottom of the faucet next to the hot and cold hoses. Continue pushing the hose through the faucet body until the pull out spray handpiece engages in the spout opening.
10. Screw the spray hose connection into the remaining pipe connection, ensuring the small rubber sealing washer provided in the bag is fitted in the remaining pipe connection to form a water tight seal.
11. Attach the lead weight to the spray hose using the screws provided. The screws are used to assemble the two halves of the lead weight around the hose. The optimum position for the lead weight is at the bottom of the front loop of the spray hose.
12. Flush pipework thoroughly.
13. Connect the hoses to their respective water supplies (see over page). Two rubber washers are provided for the flexible hose supply connections. Machined nipple ends are required to ensure a seal to the flexible hose nuts and the rubber washers.

We recommend that this product is installed by a licensed plumber.

## THE METHVEN GUARANTEE

The warranty statement shall apply to all tapware & showers supplied by Methven  
 For more information visit [www.methven.com](http://www.methven.com)

THIS WARRANTY ISSUED BY: Methven Australia Pty Ltd, Melbourne Australia