

Shower Installation

Refer to diagram at right.

The tools you will need: adjustable spanner

1. Unscrew your old shower anti-clockwise.
2. Clean the exposed thread and bind clockwise with thread sealing tape.
3. Fit the elbow to the wall. Tighten only by hand.
4. Ensure that the elbow is vertical so that the hose hangs straight down.
5. Fit the rail as per instructions at a suitable height and position.
6. Connect the hose and handset using the washers supplied. Hand tighten only.

NOTE: Never use abrasives to clean this product. Clean regularly with contamination free warm soapy water or damp soft cloth.

STEP 1

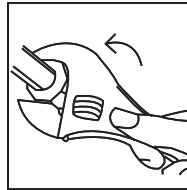

STEP 2

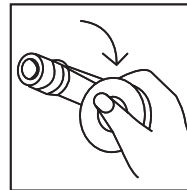

STEP 3

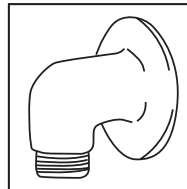

Rail Shower Set with Apollo Rail and Soap Dish (where provided)

Installation Guide

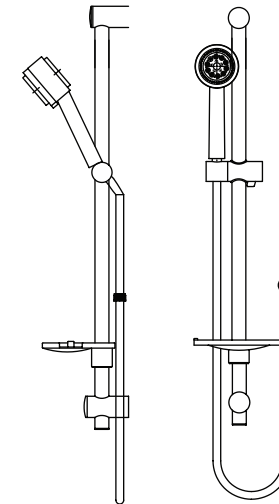

Illustration may not reflect actual product shape.

HOSE INSTRUCTIONS

STOP

DO NOT INSTALL HOSE THIS WAY.

Outer hose will pinch the inner tube and lead to failure.

Such damage is easily recognised and not covered by warranty. Install correctly with a wall elbow (not included).

For commercial, industrial or parahealth use; ask your store consultant for correct shower selection.



IMPORTANT

Please read all of the instructions before installation

WELS

REFER TO
PRODUCT
FOR STAR
RATING

NOV 2009

97-9271

Methven Australia Pty Ltd

ABN 15 104 813 390

Melbourne, Australia

www.methven.com

www.methven.com

