

# Centique Sink Mixer with Vegetable Spray

## Important

All pipework must be thoroughly flushed prior to installation of mixer. NEFA inline filters must be installed on both hot and cold supplies.

This mixer is designed to work in mains pressure situations only, minimum supply pressure 150 kPa, maximum supply pressure 1000 kPa. If your local supply exceeds 1000kPa ensure a NEFA Pressure Limiting Valve is fitted.

Not recommended for uncontrolled heating systems such as wetbacks or solar heating units, unless a NEFA Temperature Limiting Valve is fitted. Maximum supply temperature 80°C. Two non-return valves are fitted in the handpiece.

## Installation

Cut a 40mm diameter hole through the bench top. Ensure the thickness of the bench top does not exceed 30mm.

Place one of the large flat rubber sealing washers (provided in a separate bag) over the tail pipes and hose and push it up to fit against the underside of the sink faucet.

Secure the "hot" hose into the left hand of the two shorter pipes when viewed from the front. Secure the "cold" hose into the right hand of the two shorter pipes when viewed from the front.

Place the mixer body and hoses through the hole cut in the bench top. (NB: The hoses will need to be placed through the hole one at a time).

Place the remaining large rubber ring and metal disc over the hoses to form a seal on the underside of the bench.

Secure the faucet in place using the backnut, against the underside of the bench.

Remove the large washer from the package containing the lead weight and insert it in the large conical end of the vegetable spray hose.

Screw the vegetable spray handpiece into the conical end of the vegetable spray hose, ensuring firm seal is made with the sealing washer within the hoses conical end fitting.

Place the smaller threaded end of the vegetable spray hose through the faucet spout opening. Push the hose down the spout and through the faucet body until it exits out the bottom of the faucet next to the hot and cold hoses. Continue pushing the hose through the faucet body until the vegetable spray handpiece engages in the spout opening.

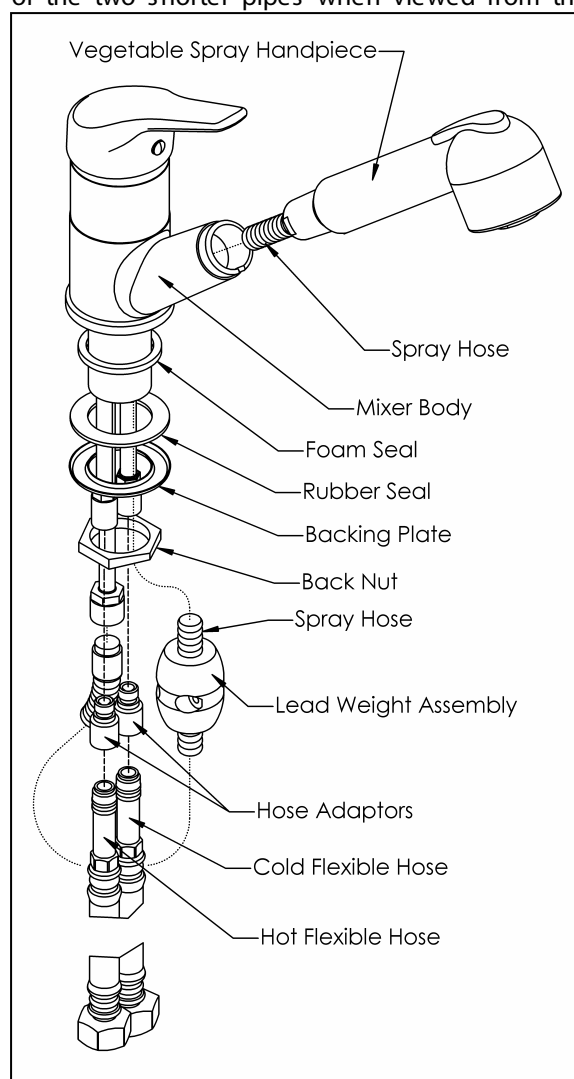

Screw the vegetable hose connection into the remaining pipe connection, ensuring the small rubber sealing washer provided in the bag with the lead weight is fitted in the remaining pipe connection to form a water tight seal.

Attach the lead weight to the vegetable spray hose using the screws provided. The screws are used to assemble the two halves of the lead weight around the hose. The optimum position for the lead weight is at the bottom of the front loop of the vegetable spray hose.

Flush pipework thoroughly.

Connect the hoses to their respective water supplies. Two rubber washers are provided for the flexible hose supply connections. Machined nipple ends are required to ensure a seal to the flexible hose nuts and the rubber washers.

### Flexible Hose Requirements

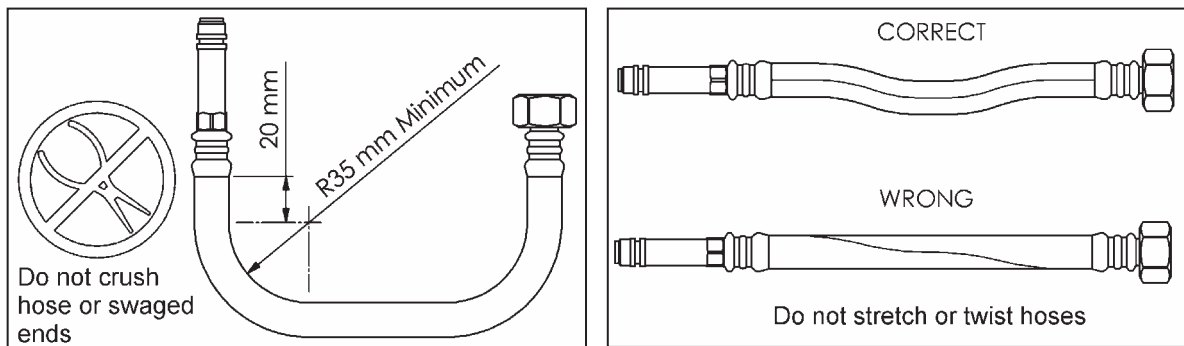

### **Care and Cleaning:**

Never use abrasives or abrasive cleaning agents to clean this product. Clean regularly with contamination free warm soapy water and a damp soft cloth.

---

Methven warrants this product against manufacturing defects and that it is suitable for use under the general operating conditions specified in this instruction sheet. However, regional regulations apply and may affect your warranty. Please refer to [www.methven.com](http://www.methven.com) or call customer service for full details.

---

METHVEN LIMITED \* 41 Jomac Place \* Avondale \* Auckland \* New Zealand  
phone : 0800 804 222      fax : 0800 805 222      website: [www.methven.com](http://www.methven.com)