

## PAXTON BASIN MIXER

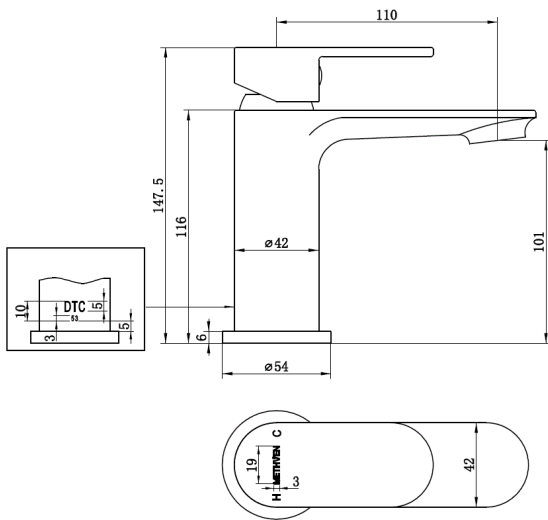

**CONSTRUCTION:** Brass

**CARTRIDGE/VALVE TYPE:** 35mm Ceramic Cartridge

**SUPPLY:** Suitable For Low Pressure Systems

**INLET CONNECTIONS:** 1/2" BSP

**WORKING PRESSURES:** 0.3 - 5.0 bar

**OPERATION:** Single lever flow and temperature control

- Suitable For A Single Hole Basin
- Single Lever Operation
- Long Life 35Mm Ceramic Cartridge
- Fitted With 4 Litre Per Minute Directional Flow Regulator
- Complete With M10\*1\*400Mm, G1/2" Stainless Steel Flexible Hoses
- Includes Press Top Waste
- Tap Height: 147.5Mm
- Suitable For All Water Pressures

PABMCP

Chrome

### Open Outlet Flow (Bar - l/min)

BAR	0.1	0.3	0.5	1.0	2.0	3.0	4.0	5.0
<b>SPOUT FLOW</b>	1	1.8	2.5	3.3	3.5	3.7	3.8	3.8



2206351



Please Note: Flow rate will be dictated by installation configurations.  
 Please ensure to check the appropriate flow restrictor information if applicable.  
 \*Please refer to website for full warranty details.

**FREEPHONE: 0800 195 1602 | FAX ORDERS: 08444 068 690 | EMAIL: SALES@UK.METHVEN.COM**

methven.com

THE INFORMATION ON THIS SPECIFICATION DOCUMENT WAS CORRECT AT THE DATE OF ISSUE. SOME VARIATION MAY OCCUR DUE TO THE MANUFACTURING TOLERANCES AND SITE SPECIFIC CONDITIONS.