

## PAXTON BATH SHOWER MIXER

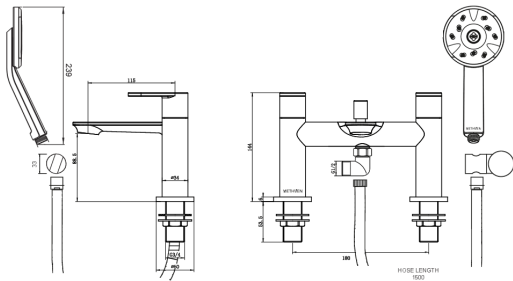

**CONSTRUCTION:** Brass

**CARTRIDGE/VALVE TYPE:** ¼ Turn Ceramic Disc

**SUPPLY:** Suitable For Low Pressure Systems

**INLET CONNECTIONS:** ¾" BSP

**WORKING PRESSURES:** 0.1 - 5.0 bar

**OPERATION:** Separate Flow And Temperature Controls

- Satinjet® Technology Twin Jets Of Water Collide Into Thousands Of Tiny Droplets To Deliver Voluminous Shower Coverage
- Water Efficient Without Compromising Performance
- Delivers A Great Shower At A Lower Flow Rate 5.5Lpm
- Suitable For A Two Tap Hole Bath
- Deck Mounted
- ¼ Turn ¾" Male Quarter Turn Ceramic Disc Valves
- Metal Back Nuts
- Suitable For All Water Pressures

### PABSMCP

### Chrome

#### Open Outlet Flow (Bar - l/min)

BAR	0.1	0.3	0.5	1.0	2.0	3.0	4.0	5.0
<b>SPOUT FLOW</b>	7.6	11.7	15.7	22.8	32.8	39.6	44.2	48.9
<b>HANDSET FLOW</b>	1.6	2.3	3	4.1	5.3	5.8	5.6	0



2307780



2206334



Please Note: Flow rate will be dictated by installation configurations.  
Please ensure to check the appropriate flow restrictor information if applicable.  
\*Please refer to website for full warranty details.

**FREEPHONE: 0800 195 1602 | FAX ORDERS: 08444 068 690 | EMAIL: SALES@UK.METHVEN.COM**

[methven.com](http://methven.com)

THE INFORMATION ON THIS SPECIFICATION DOCUMENT WAS CORRECT AT THE DATE OF ISSUE. SOME VARIATION MAY OCCUR DUE TO THE MANUFACTURING TOLERANCES AND SITE SPECIFIC CONDITIONS.